

# ALDEA

AT TRAVATA

Luxury Living for 55 and Better in Irvine

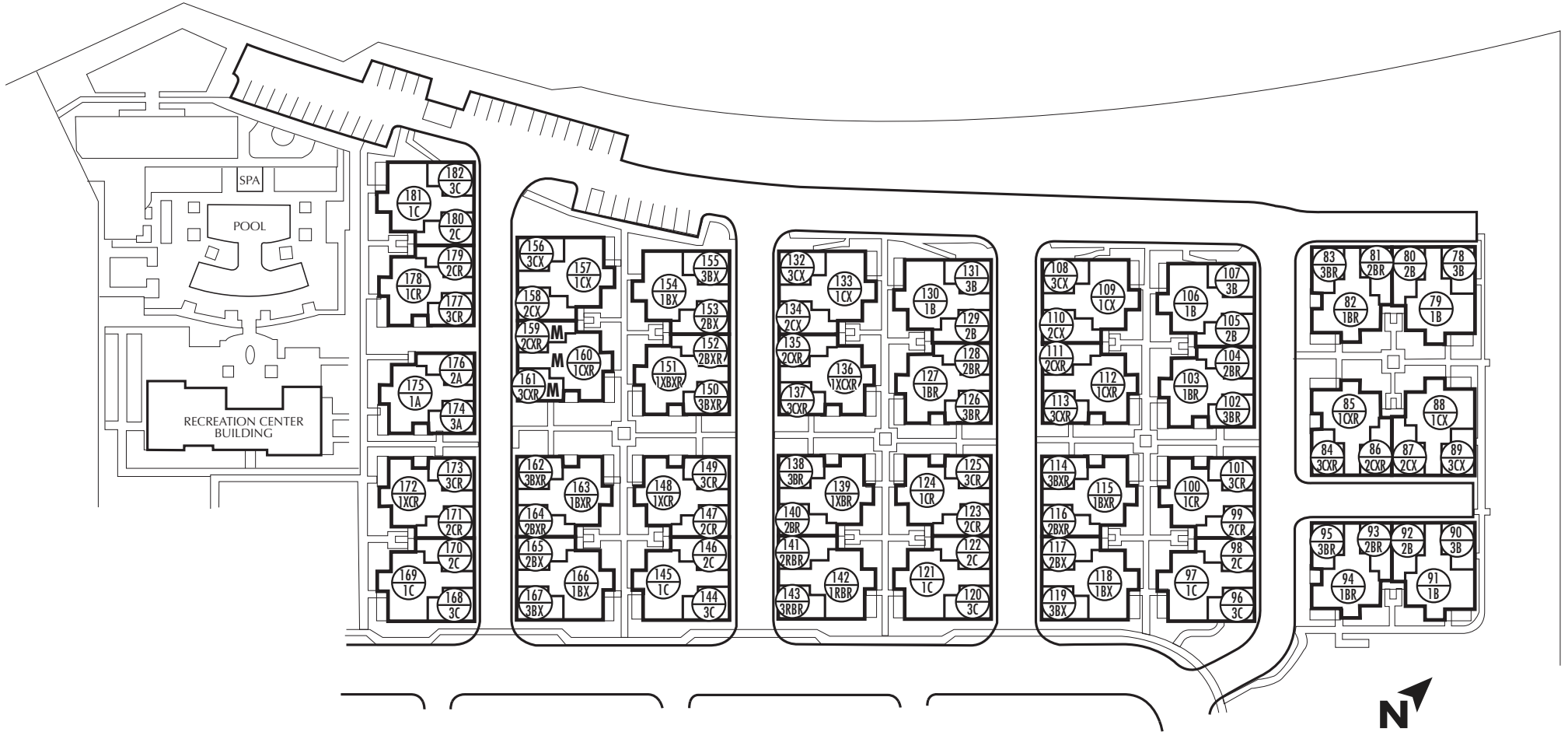

# LENNAR®

309 CARLOW | IRVINE, CA 92618 | 888-220-5502 | [LENNAR.COM/TRAVATA](http://LENNAR.COM/TRAVATA)

Pursuant to the Fair Housing Act, housing is intended for occupancy by at least one person 55 years of age or older per unit. Price is subject to change without notice. Stated dimensions and square footage are approximate and should not be used as representation of the home's precise or actual size. Any statement, verbal or written, regarding "under air" or "finished area" or any other description or modifier of the square footage size of any home is a shorthand description of the manner in which the square footage was estimated and should not be construed to indicate certainty. Bay size may vary from home to home and may not accommodate all vehicles. "Masterfully Planned by the Irvine Company" means that the Irvine Company created the master land plan for all Irvine Company communities. The "master land plan" includes the overall entitlement and design of each community but does not include the design, construction and sale of homes. The design, construction and sale of homes is the sole responsibility of community builders. The Irvine Company is not designing, constructing or offering homes for sale in any community. Copyright © 2018 Lennar Corporation. All rights reserved. Lennar, the Lennar logo, CalAtlantic Homes and the CalAtlantic logo are U.S. registered service marks or service marks of Lennar Corporation and/or its subsidiaries. Lennar Homes of California, Inc. License #728102. Lennar Sales Corp. DRE License #01252753. CalAtlantic Group, Inc. DRE License #02058246. Ryland Homes of California, Inc. 00352900. CalAtlantic Group, Inc., 641665. Ryland Homes of California, Inc., 54648. Standard Pacific of Orange County, Inc., 923048. BMR Construction, Inc., 830955. 8/18

